



# APOLLO® CLASS 600 FLANGE VALVES DELIVER HIGH PERFORMANCE FEATURES

Apollo® 87A-F, 88A-F, and 88L-F Series ASME Class 600 flange ball valves are available in Stainless Steel, Carbon Steel and Low Temp Carbon Steel in sizes 1" to 8" (DN25 to DN200). Other alloys such as Alloy 20, Hastelloy, Duplex & Super Duplex, Nickel & Nickel-Copper alloys and Titanium are available upon request.

## STANDARD FEATURES

- Cast, machined, assembled, and tested in U.S.A.
- Fully compliant to ASME B16.34 & API 608
- Two Position Locking Device (Valves 6" and smaller)
- Valves with PTFE Stem Seals will be Adjustable Chevron Style
- ISO 5211 Mounting Pad Bolt Pattern
- SS Balls & Stems Available in Carbon Steel Valves (Standard in Low Temp CS & SS Valves)
- Slot Vented Ball for Thermal Expansion
- Rated up to 150 psig Saturated Steam

Except where specifically noted all valves within this family of products include all listed features as standard.

- Optional rating to 250 psig Saturated Steam (Requires the -24-80 Options or -38 Option)
- API 607 Fire Safe (Requires the -24-80 Options)
- Anti-static Grounded Ball and Stem
- Blow-out Proof Stem Design
- Cast Boss for Bleed / Drain Port
- Vacuum Service to 29 inches of Hg
- NACE MR0175 (2000) and MR0103 (2003) Compliance

## STANDARD COMPLIANCE

- ASME B16.5 "Pipe Flanges and Flanged Fittings"
- ASME B16.10 "Face to Face Dimensions of Valves"
- ASME B16.34 "Valves - Flanged, Threaded, and Welding End"
- ASME B31.1 "Power Piping"
- ASME B31.3 "Chemical Plant and Petroleum Refinery Piping"
- ASME B31.8 "Gas Transmission and Distribution Piping Systems"
- API 607 "Fire Test - Soft Seated Quarter Turn Valves"

Except where specifically noted all valves within this family of products complies with the requirements of this listed standard.

- API 608 "Ball Valves - Flanged, Threaded, and Welding End"
- MSS SP-25 "Standard Marking System for Valves"
- MSS SP-61 "Pressure Testing of Steel Valves"
- MSS SP-72 "Ball Valves with Flanged or Butt-welded Ends"
- NSF-372 Drinking Water System Components - Lead Content
- NSF/ANSI 61 (2010) Section 8, Annex F & G

## ASME CLASS 600 FLANGE VALVES

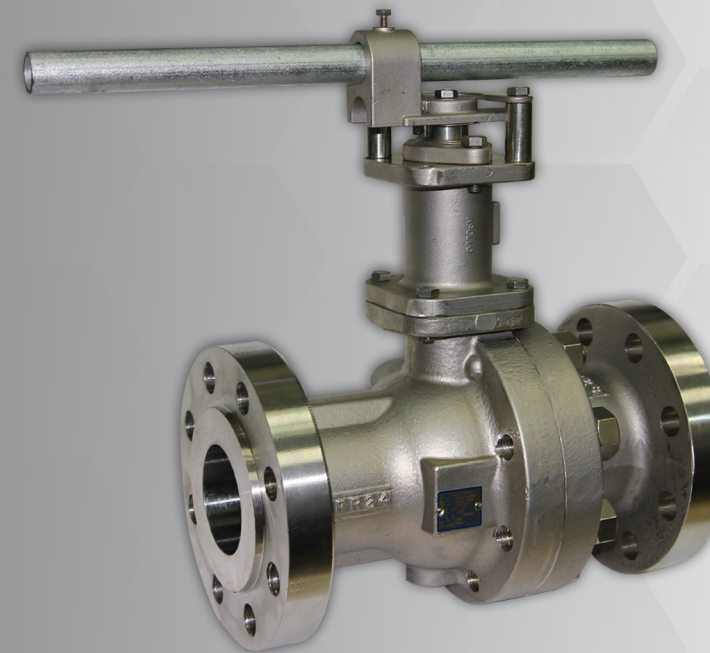

Class 600 Valve with 4" bonnet extension



Class 600 Valve with Actuator

## STANDARD MATERIALS LIST

### 87A-F

PART	MATERIAL
Body	ASTM A351-CF8M
Retainer	ASTM A351-CF8M
Ball	ASTM A351-CF8M or ASTM A276 Type 316
Stem	ASTM A276 Type 316
Seats	Defined by Selected Seat Suffix*
Body Seals	Defined by Selected Seat Suffix*
Stem Seals	Defined by Selected Seat Suffix*
Stem Bearing	Defined by Selected Seat Suffix*
Grounding Spring	316 Stainless Steel
Packing Gland	ASTM A276 Type 316

\* -80 (Multiseal) | -90 (Devlon) | -21 (UHMWPE) | -38 (PEEK)

See tech sheets for full product details

PART	MATERIAL
Stem Nut	ASTM A194 Grade 8
Lever & Grip	316 Stainless Steel w/ Vinyl Grip
Gland Plate	316 Stainless Steel
Stops	ASTM A276 Type 316
Lock Plate	302 or 304 Stainless Steel
Stop Screws	18-8 Stainless Steel
Gland Plate Screws	ASTM A193-B8
Body Joint Stud	ASTM A193-B8 Grade B8M
Body Joint Nut	ASTM A194-Grade 8
Lock Washer	302 or 304 Stainless Steel

### 88A-F

PART	MATERIAL
Body	ASTM A216-WCB
Retainer	ASTM A216-WCB
Ball	ASTM A216-WCB or ASTM A108
Stem	ASTM A108

Balance of components will be the same as 87A-F Material List

### 88L-F

PART	MATERIAL
Body	ASTM A352-LCC
Retainer	ASTM A352-LCC
Ball	ASTM A351-CF8M or ASTM A276 Type 316
Stem	ASTM A276 Type 316

Balance of components will be the same as 87A-F Material List

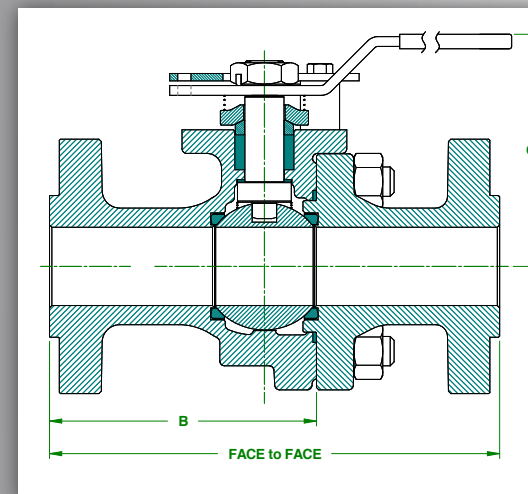

## DIMENSIONS

SIZE	FACE to FACE	B	C	WT./LBS.
1"	8.50"	N/A*	3.99"	13
1.5"	9.50"	4.93"	5.03"	33
2"	11.50"	6.82"	6.06"	53
2.5"	13.00"	7.37"	6.63"	65
3"	14.00"	8.34"	8.55"	101
4"	17.00"	8.70"	11.20"	194
6"	22.00"	13.25"	14.17"	500
8"	26.00"	14.85"	N/A	920

\*1" valve is a unibody design



**SALES & CUSTOMER SERVICE:**

Phone: (704) 841-6000

Fax: (704) 841-6020



To find a Sales Rep in your area, visit our website. [www.apollovalves.com/replocator](http://www.apollovalves.com/replocator)

**REGIONAL MANAGEMENT – APOLLO VALVES, ELKHART PRODUCTS & LASCO FITTINGS**

	AREAS COVERED	EMAIL	PHONE
<b>SENIOR MANAGEMENT</b>			
Brian Ragone	Senior VP - Sales & Marketing	brian.ragone@conbraco.com	513-200-5415
Don Russell	VP Sales - Commercial & Industrial	don.russell@conbraco.com	614-943-0688

<b>REGIONAL SALES DIRECTORS – COMMERCIAL &amp; INDUSTRIAL</b>			
Mike Bedzyk	Central/Northeast	michael.bedzyk@conbraco.com	614-619-4993
Mitch Davis	S. Central/Southeast	mitch.davis@conbraco.com	678-628-4478
Phillip Merino	West	phillip.merino@conbraco.com	702-960-9935

<b>REGIONAL SALES MANAGERS – COMMERCIAL &amp; INDUSTRIAL</b>			
Kevin Ashworth	Midsouth	kevin.ashworth@conbraco.com	757-272-6200
Keith Baca	Southeast	keith.baca@conbraco.com	615-630-3892
Mike Blair	Central	mike.blair@conbraco.com	330-413-0035
Ken Copeland	Southwest	ken.copeland@conbraco.com	623-853-5744
Ben Lauletta	Northeast	ben.lauletta@conbraco.com	518-795-4629
Wesley Reinart	S. Central	wesley.reinart@conbraco.com	214-620-9901

<b>INDUSTRIAL MARKET MANAGERS</b>			
Dave Eck	Northeast	david.eck@conbraco.com	302-268-4411
Mark Sordelet	Central	mark.sordelet@conbraco.com	260-433-7393
George Prebula	Southeast	george.prebula@conbraco.com	919-600-4107

<b>BACKFLOW MARKET MANAGERS</b>			
Pete Chapman	National Manager	pete.chapman@conbraco.com	559-577-2593
Cary Wiley	East	cary.wiley@conbraco.com	678-642-3356

<b>APOLLOXPRESS MARKET MANAGERS</b>			
John Rankel	National Manager	john.rankel@conbraco.com	702-445-0309
Todd Green	South Central	todd.green@conbraco.com	501-920-2029
Brian Jennings	North Central	brian.jennings@conbraco.com	859-394-3319
Jason Orawiec	West	jason.orawiec@conbraco.com	847-650-0170
Robert Purchia	East	robert.purchia@conbraco.com	704-960-3532

	AREAS COVERED	EMAIL	PHONE
<b>APOLLOPUSH MARKET MANAGERS</b>			
George Dragosz	Northeast	george.dragosz@elkhartproducts.com	574-206-3953
Mark Schanback	Southeast	mark.schanback@conbraco.com	407-916-9626
Jeremy Small	Central	jeremy.small@conbraco.com	214-766-2106

<b>WROT/CAST MARKET MANAGERS</b>			
Cindy Goodwin	National Manager	cindy.goodwin@elkhartproducts.com	517-294-0007

<b>CANADA</b>			
Jeff Cooper	General Manager	jeff.cooper@conbraco.com	416-451-9336
Andy Fretz	Commercial	andy.fretz@conbraco.com	647-281-3161
Jim Todman	Industrial	jim.todman@conbraco.com	905-407-8385

<b>LASCO FITTINGS REGIONAL SALES MANAGERS – IRRIGATION</b>			
Jimmy White	VP Sales & Marketing	jwhite@lascofittings.com	731-234-2372
Bryan Juwig	Sr. VP Sales & Marketing	bjuwig@lascofittings.com	901-233-3046
David Beyer	Direct Sales	dbeyer@lascofittings.com	561-718-9379
Mitchell Sellers	Northeast	msellers@lascofittings.com	484-354-4639
Don Caver	Southeast	dcaver@lascofittings.com	469-628-4918
Bryan Jackman	West	bjackman@lascofittings.com	714-673-5875
Rick Williamson	Eastern Specifications Manager	rwilliamson@lascofittings.com	386-451-2307

<b>INTERNATIONAL SALES MANAGERS</b>			
Bill McNamara	Director of International Sales	bill.mcnamara@elkhartproducts.com	1-574-903-3821
JR Jefferson	Central/South America & the Caribbean	jr.jefferson@conbraco.com	1-832-220-3783
Brencliff Group	Australia, New Zealand	petermcl@brencliff.com	61 477 223110
Pegler Yorkshire	United Kingdom	adrian.byrne@conbraco.com	44-7740-449858
Pegler Yorkshire Mid East	Middle East/India	peter.pydubai@gmail.com	971-4-454-2353
	Europe/Africa/Israel	customersupport@conbraco.com	1-704-841-6000

For more information about **Apollo Valves, Elkhart Products Corporation**, and our family of **AMERICAN MADE** products, contact:



# ASME B16.34 CLASS 600

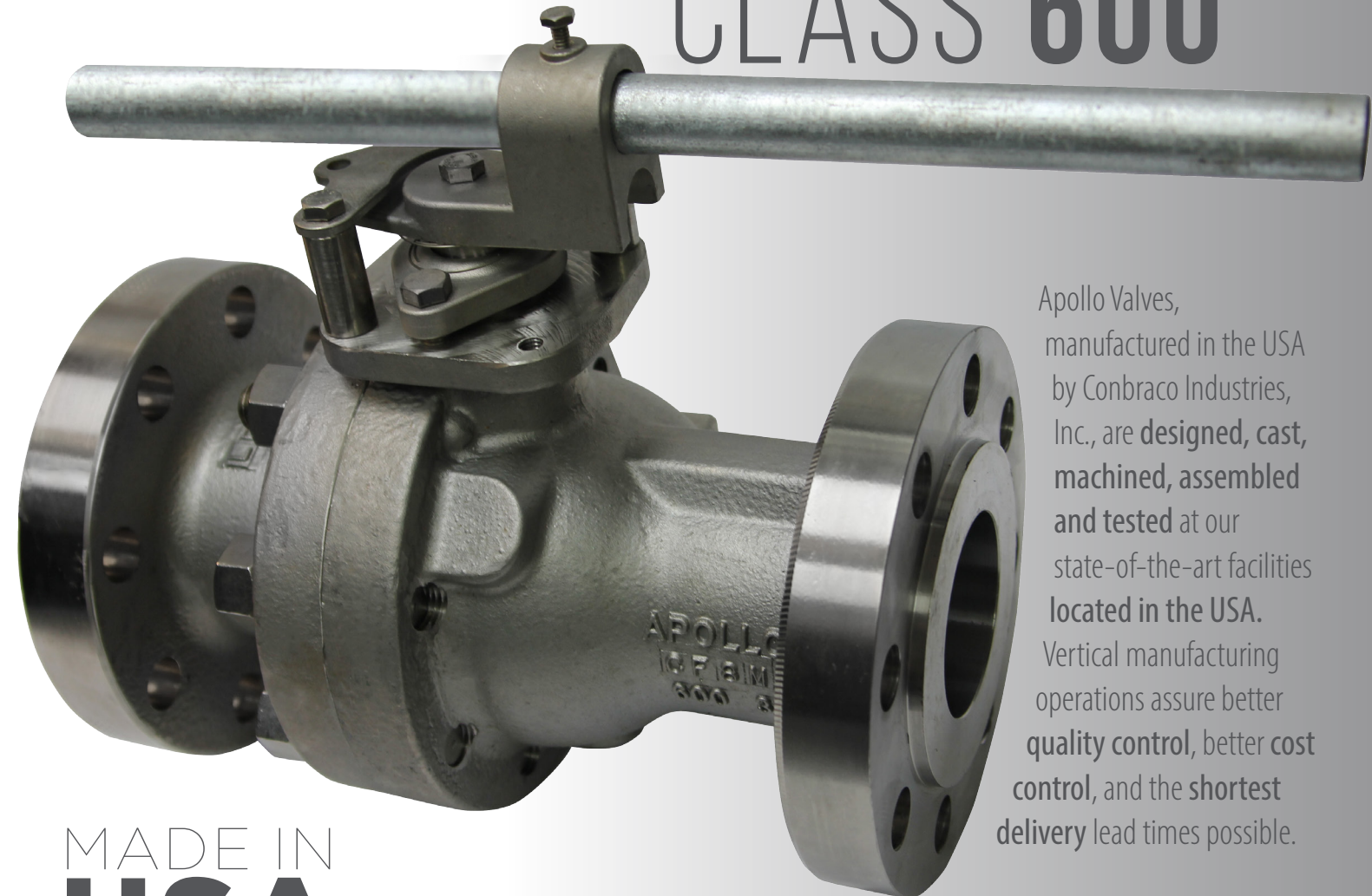

MADE IN  
**USA**

Apollo Valves, manufactured in the USA by Conbraco Industries, Inc., are designed, cast, machined, assembled and tested at our state-of-the-art facilities located in the USA. Vertical manufacturing operations assure better quality control, better cost control, and the shortest delivery lead times possible.

## FULL PORT FLANGE VALVES

87A-F00 | 88A-F00 | 88L-F40